

PRESTIGEGUARD INSTALLATION GUIDE



Intertek

Sanitation Listed
Certified to NSF/ANSI 2 by Intertek

-Size of parts will differ depending on customer's order.

-Quantity of parts might differ depending on customer's order.

NEED:



4 people
needed



Phillips
Screwdriver



Level



Utility
Gloves



Wrench

Parts List:

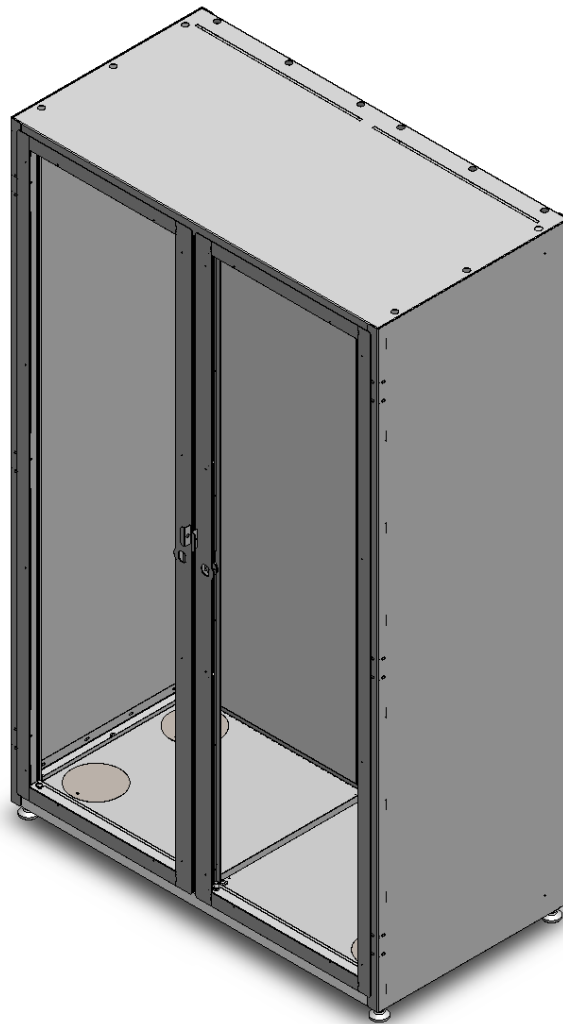

Empty Lockbox

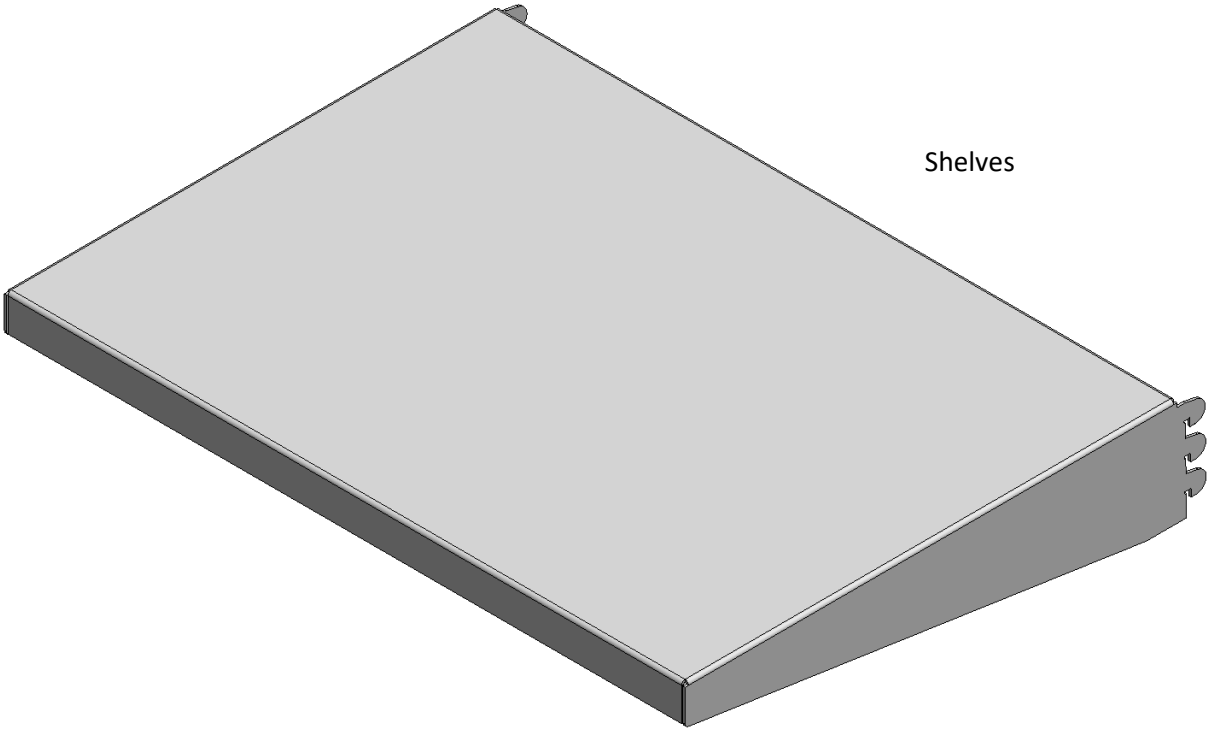

Shelves

Step 1: Move the lockbox to the place to be installed by using a pallet jack, remove the shrink wrap, cardboard and unload the unit from the pallet.

Step 2: Test the unit by plugging in the electrical cord to make sure the lights turn on.

Step 3: Using a bubble level, make sure the unit is leveled before securing the unit in place and setting shelves inside. It is important to level the unit using the 5 spots as shown in the picture to make sure the whole unit is correctly leveled.

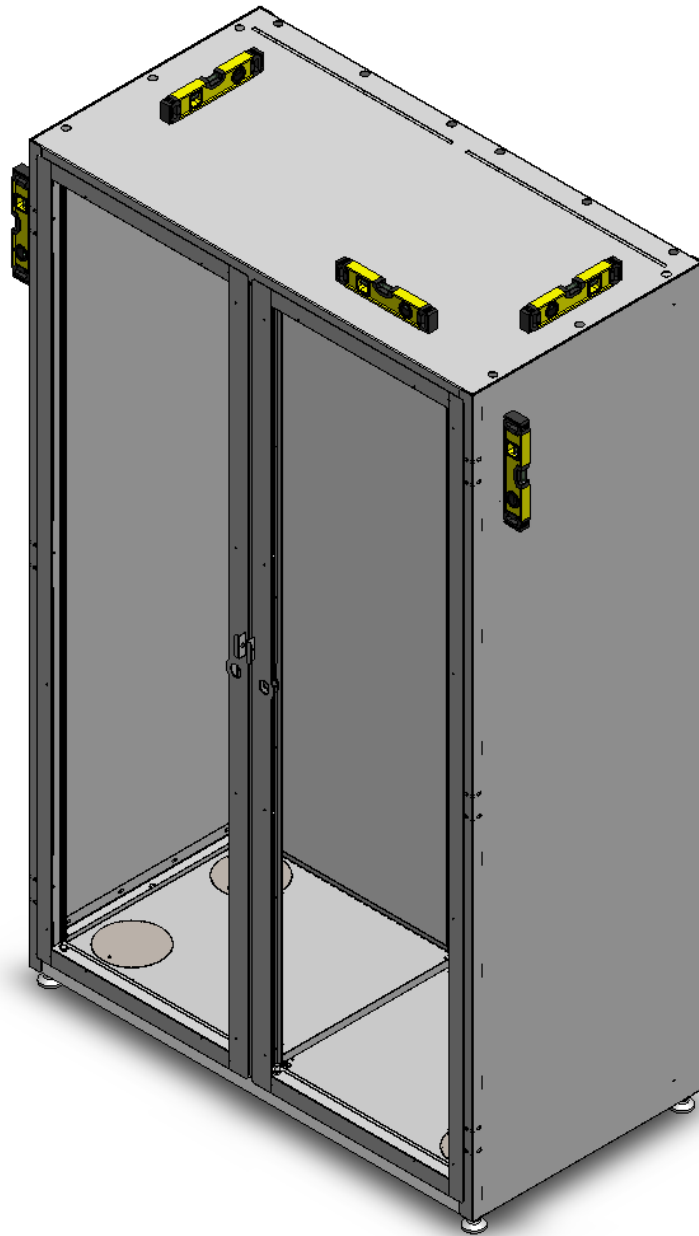

If it is required to adjust the level of the footpad, it can be done in the following way.

For the fronts, you can adjust the footpad by using a wrench on the front.

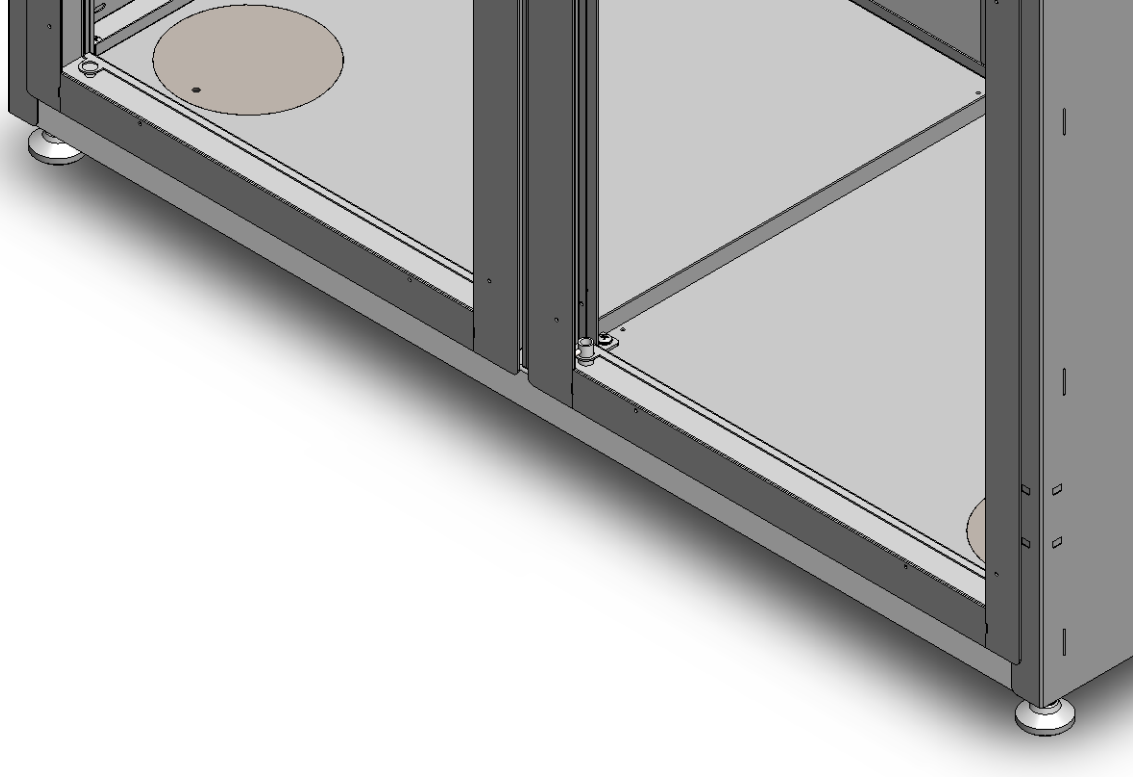

For the backs, you will just need to remove the circular plate on the inside, and adjust the footpad, then replace the circular plate.

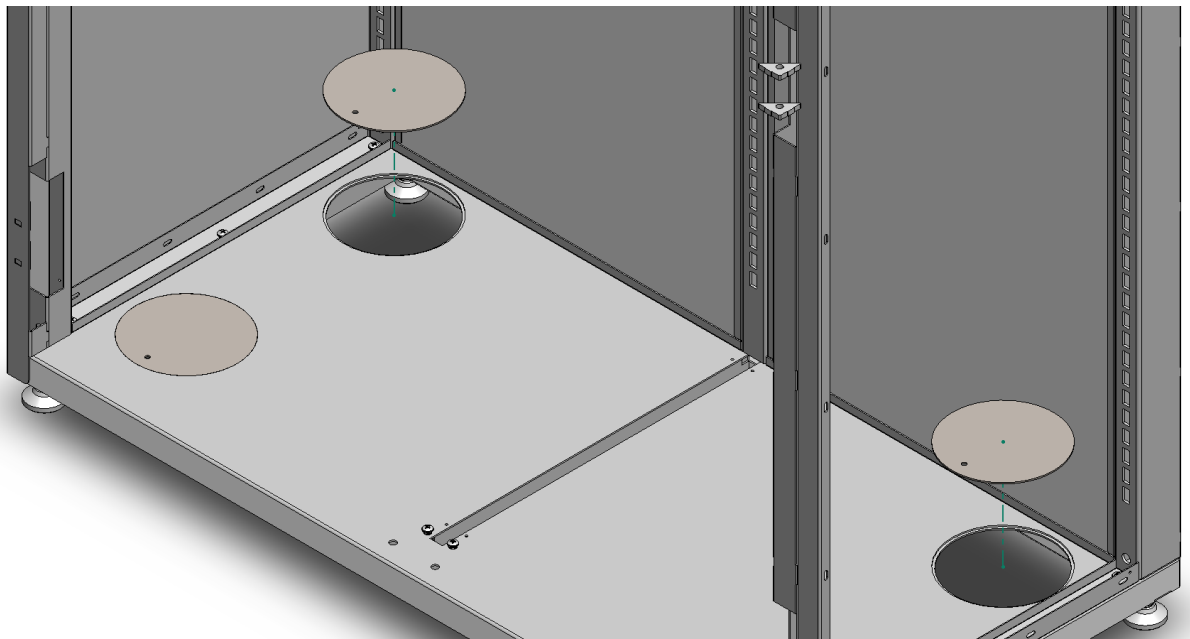

Step 4: Install the shelves inside the cabinet as desired.

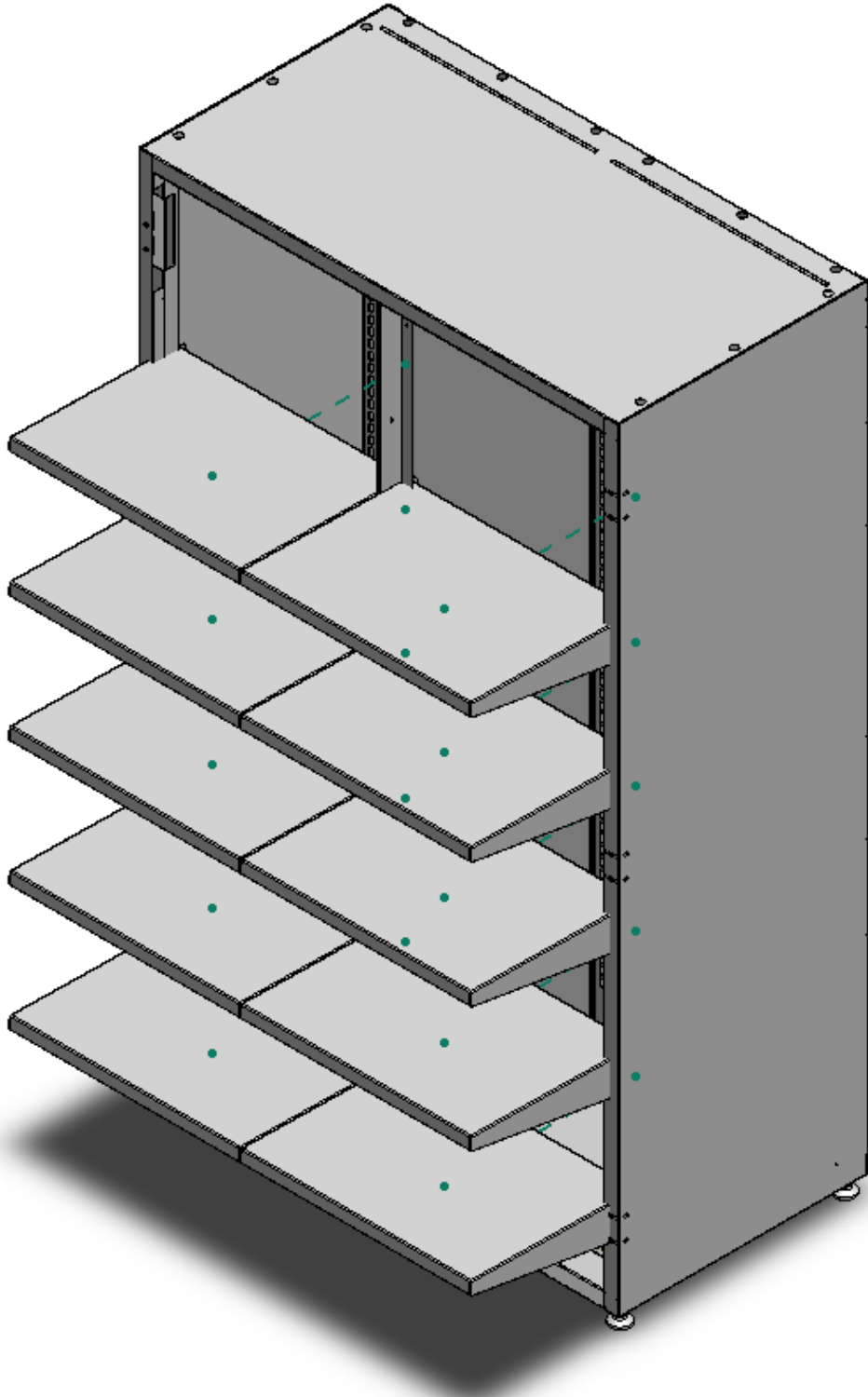

Troubleshooting

If the doors do not close or the locks do not turn, this may be due to the center mullion being out of position. Ensure the unit is leveled as shown above before adjusting mullion.

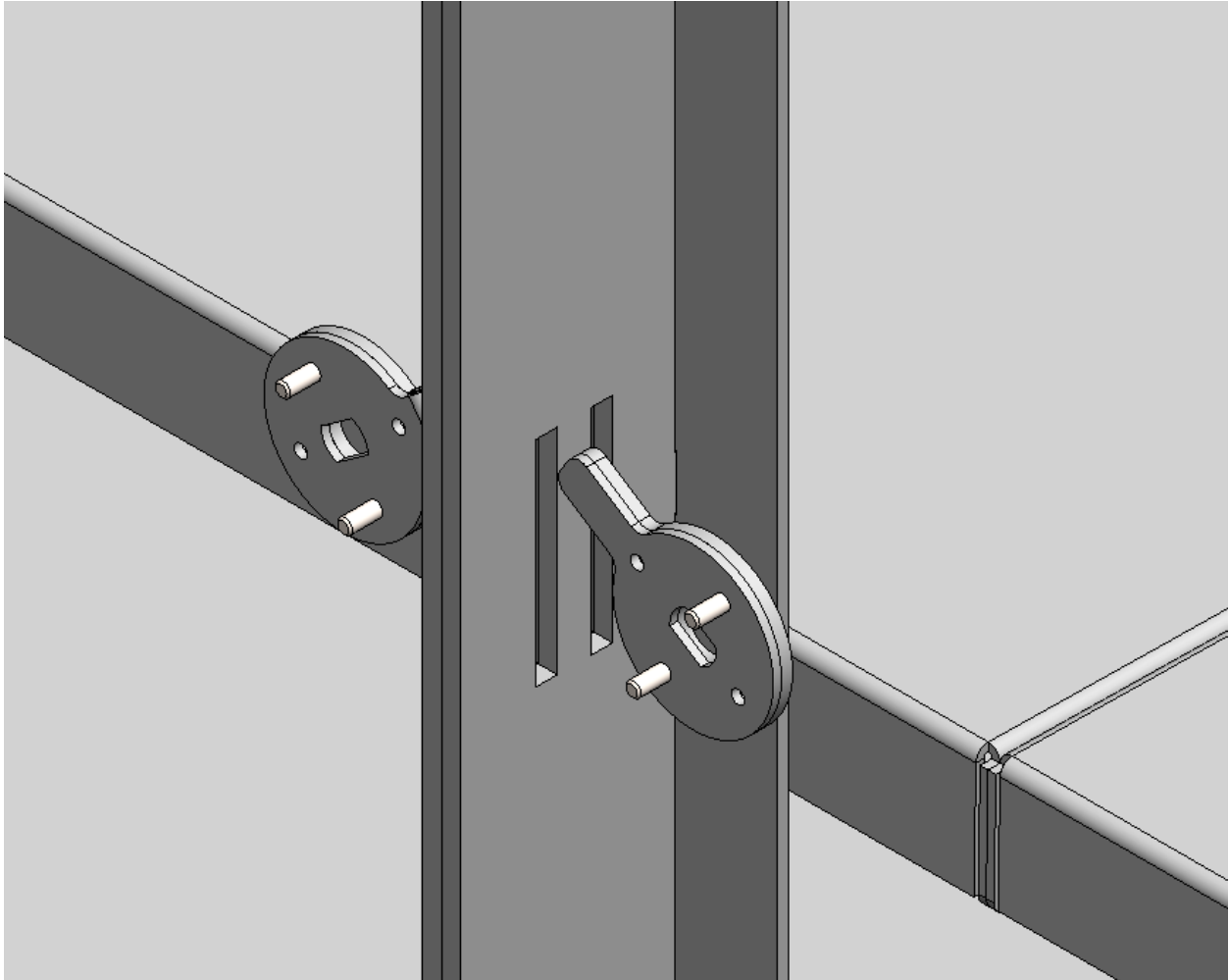

You can loosen the top two and the two bottom bolts for the center mullion and adjust the location by sliding back or front to fit the locks, then tighten again the bolts to secure the position of the center mullion.

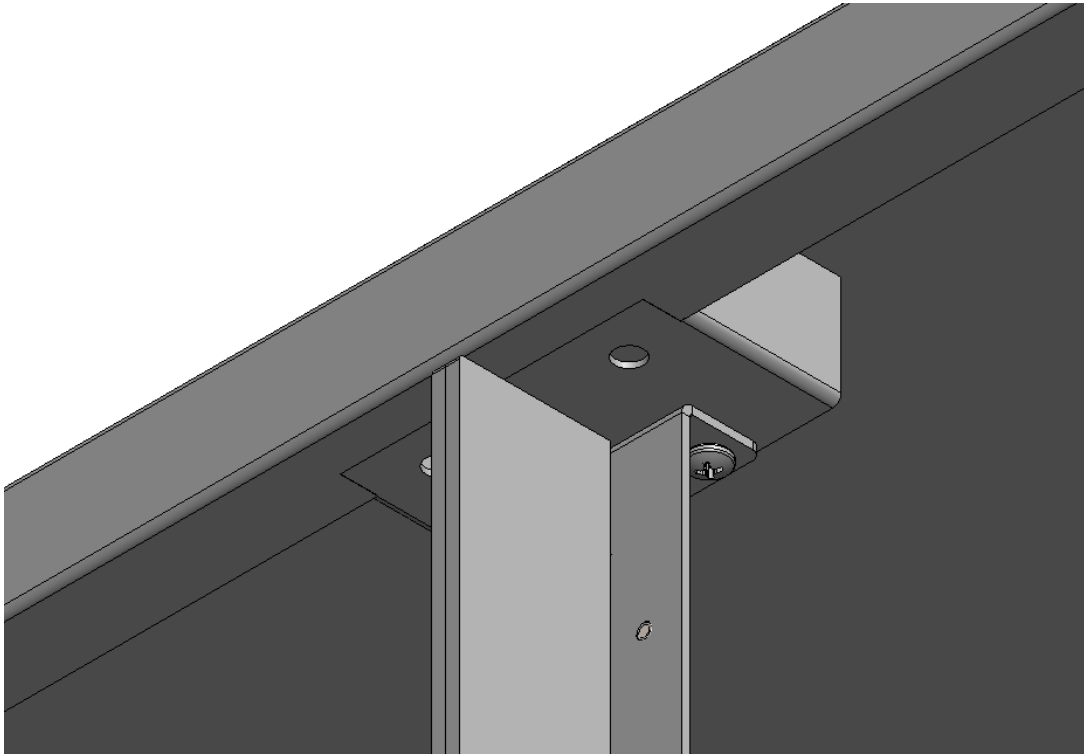
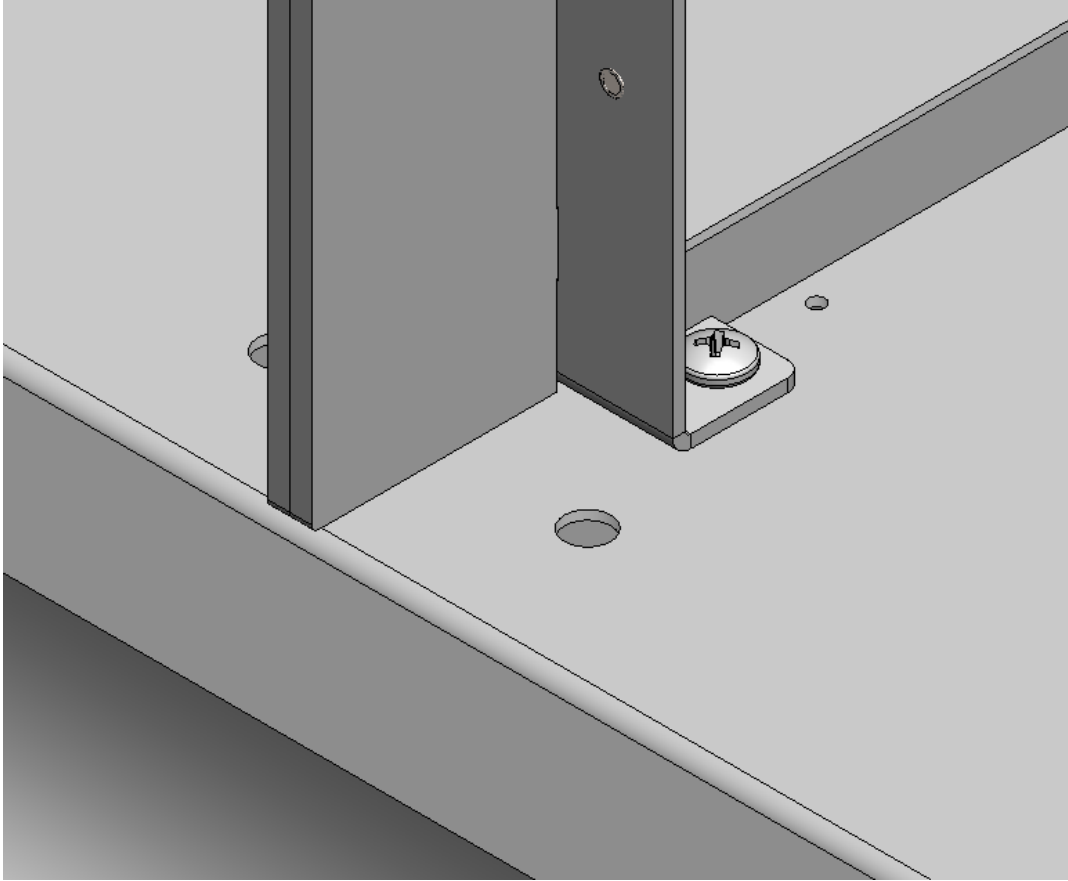

Completed Assembly:

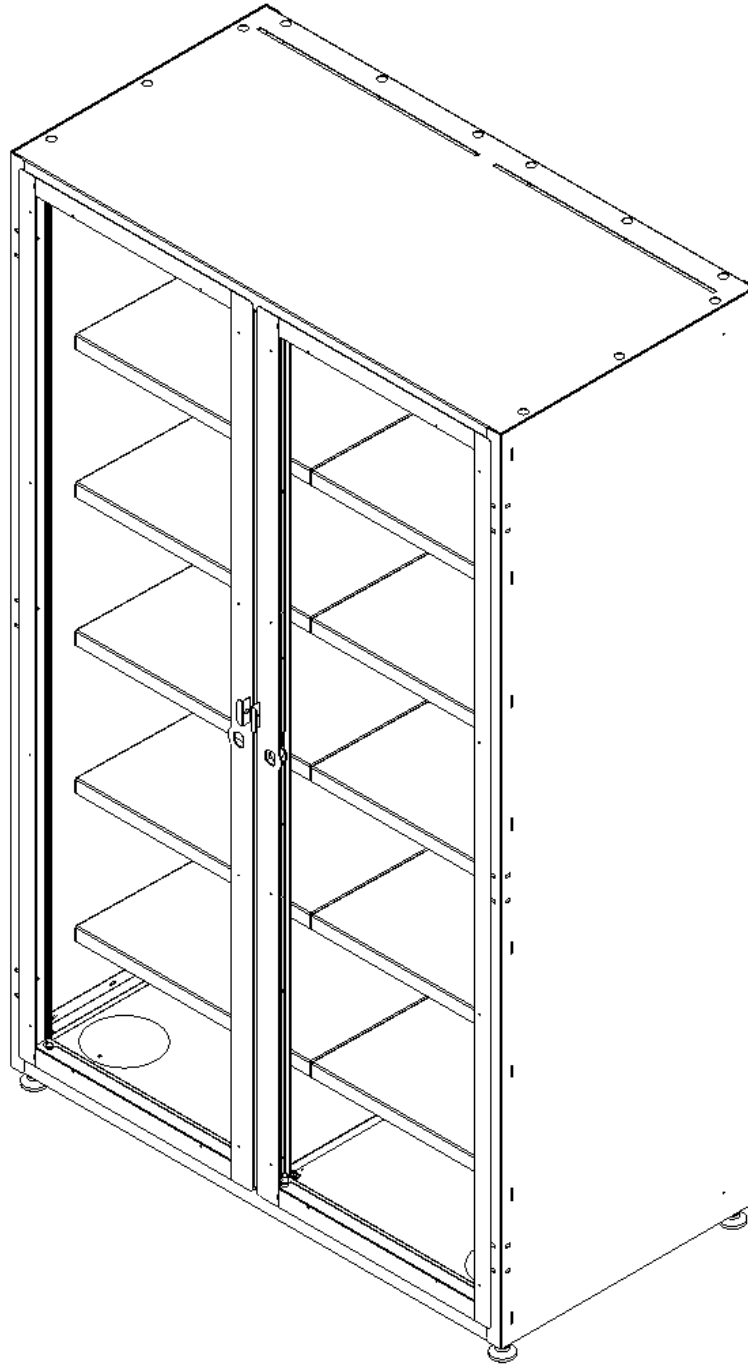

Questions?

Call Customer Service...800-323-2517