

# VERSARACK + VERSAROLLERSHELF®

## ASSEMBLY GUIDE



**Intertek**

Sanitation Listed  
Certified to NSF/ANSI 2 by Intertek

-Size of parts will differ depending on customer's order.

-Quantity of parts might differ depending on customer's order.

NEED:



Two people  
needed



1/2" Wrench & Ratchet with  
1/2" Deep Well Socket



Level



Utility  
Gloves

PARTS LIST

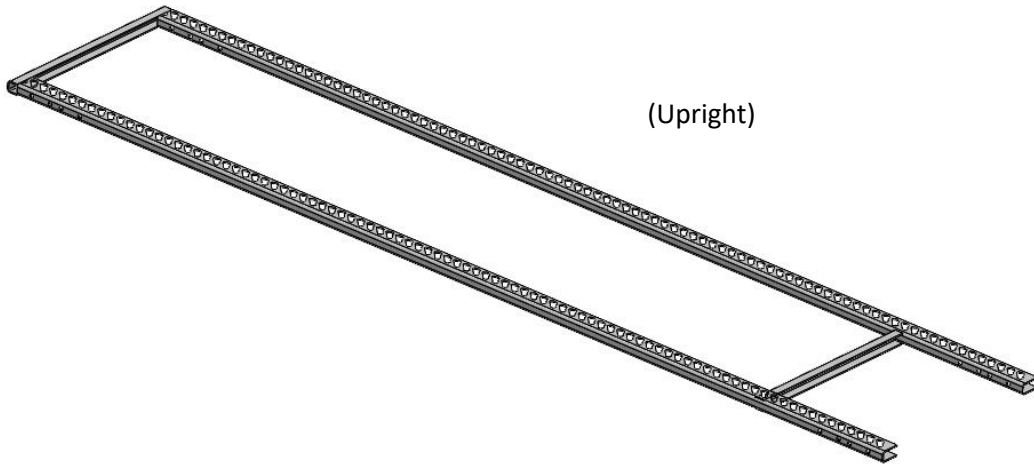

(Upright)

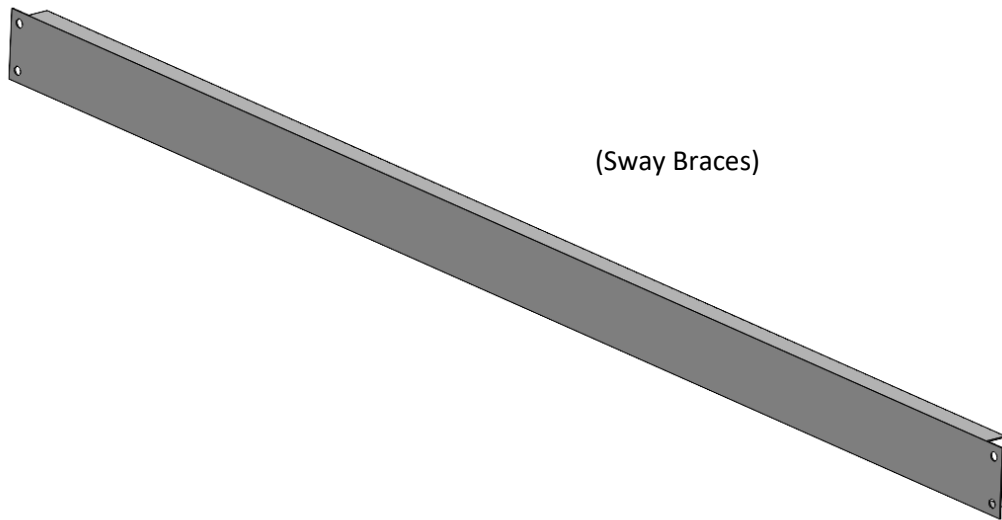

(Sway Braces)

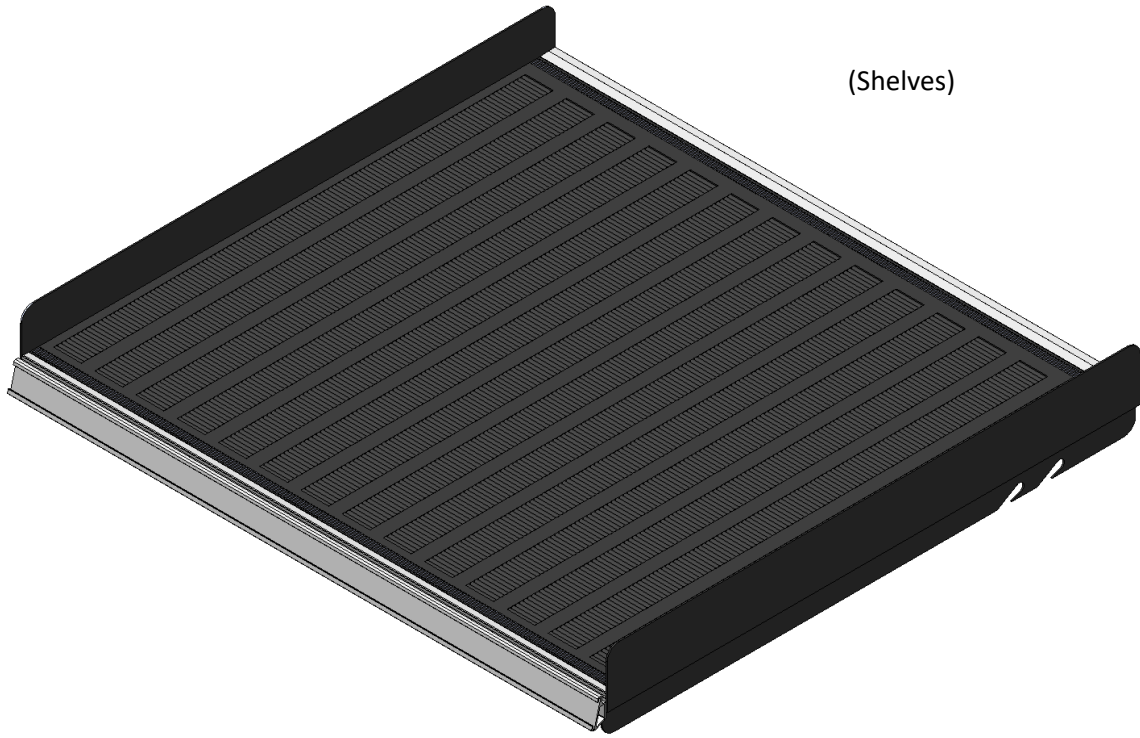

(Shelves)

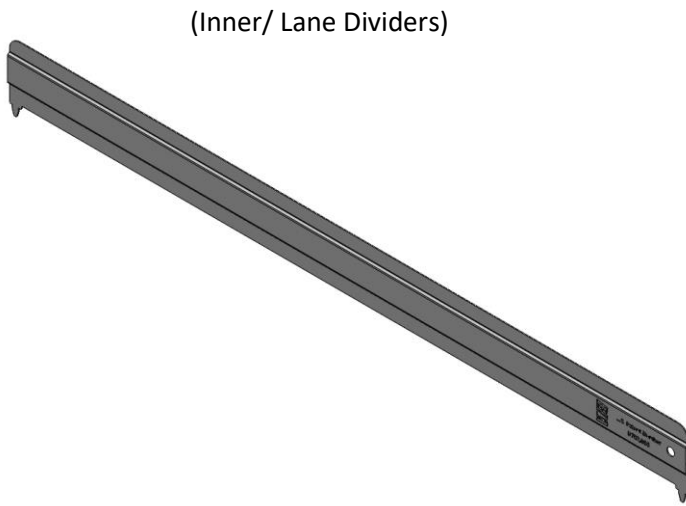

(Inner/ Lane Dividers)

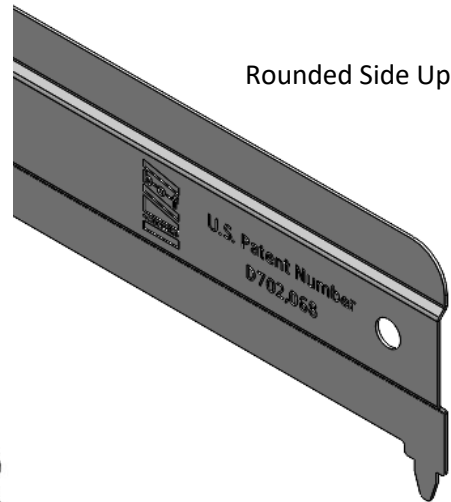

Rounded Side Up

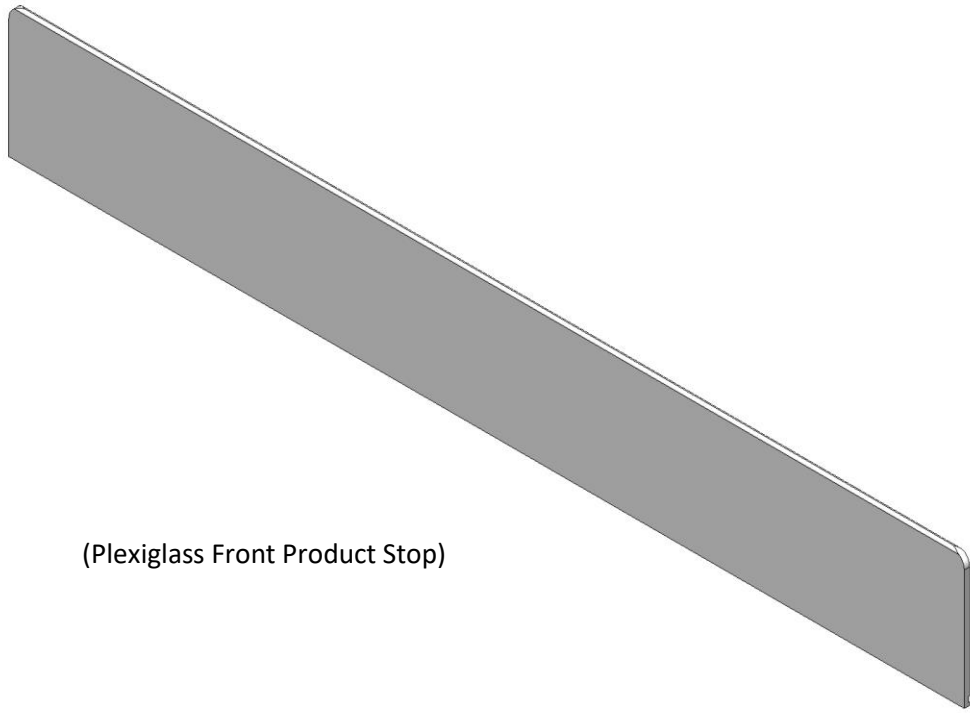

(Plexiglass Front Product Stop)

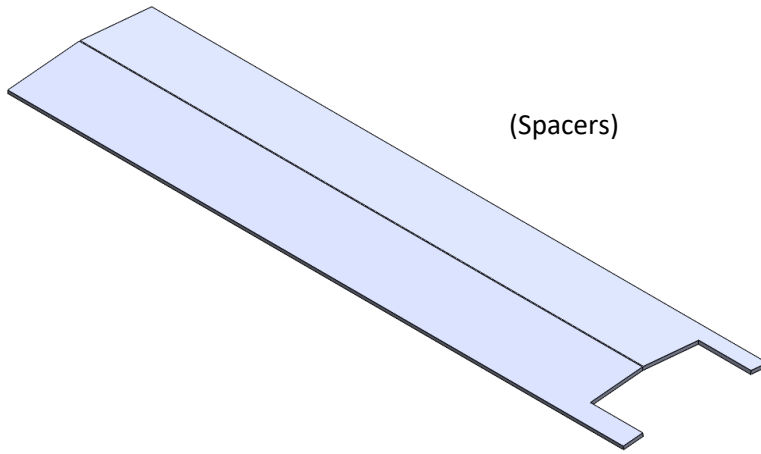

(Spacers)



Shelf Clamps

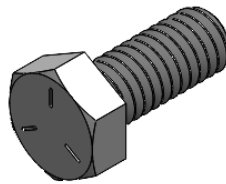

5/16" Bolt

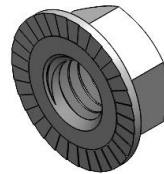

5/16" Nut

**Step 1: Tighten with fingers**, leave just finger tight until the end. Do **NOT** tighten with wrench until the end. Suggested location of sway braces are Top Front and Bottom Back. Each section must have 6 inches of sway brace.

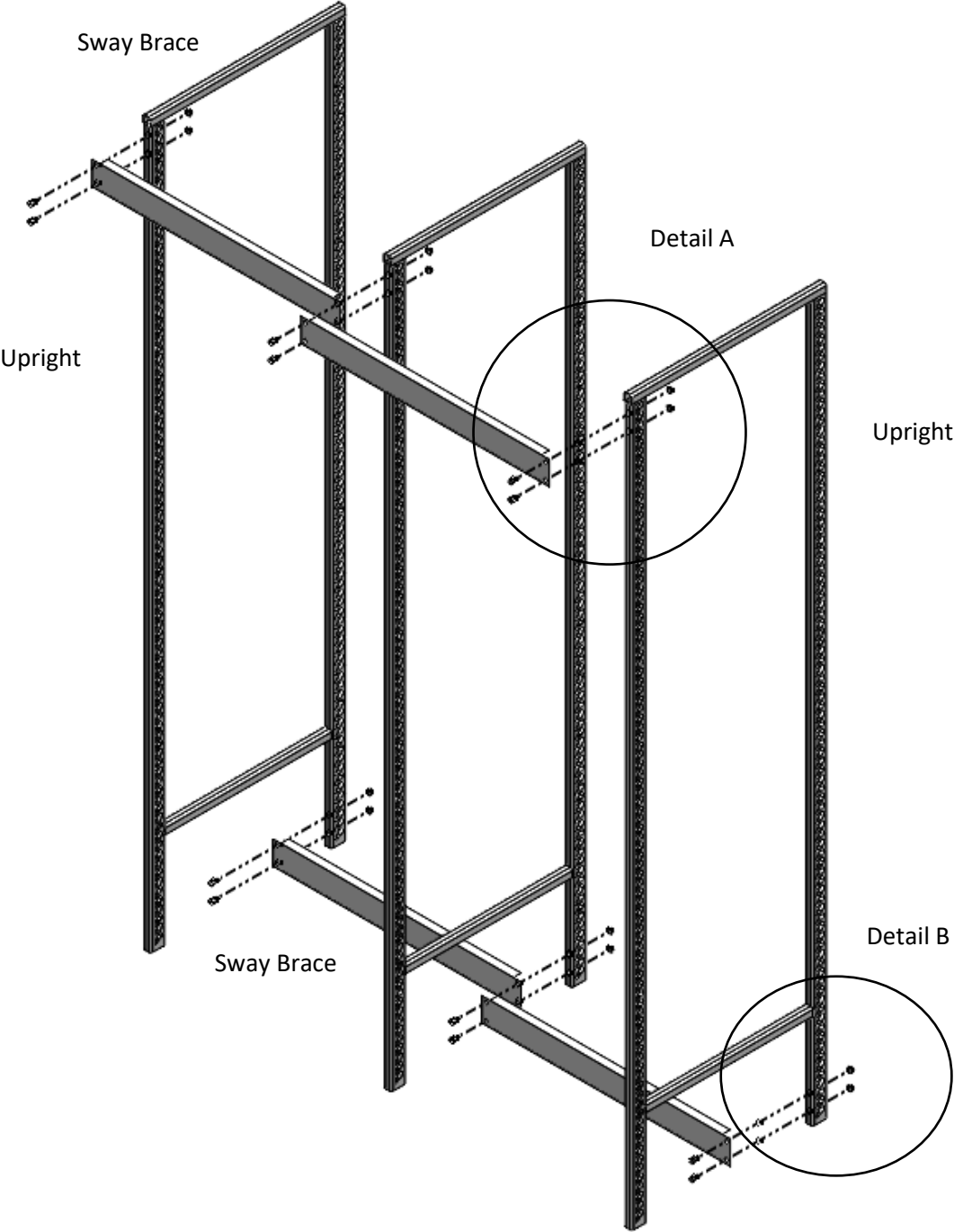

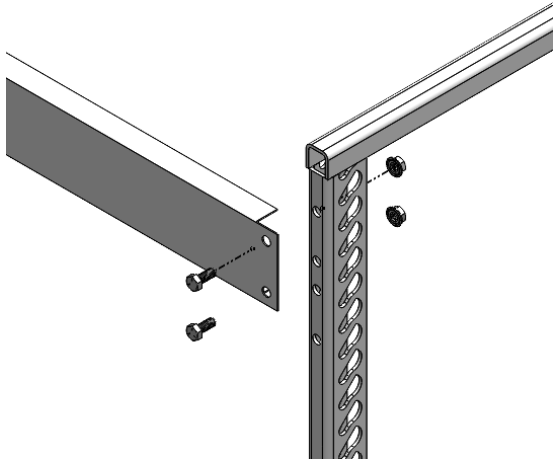

Detail A

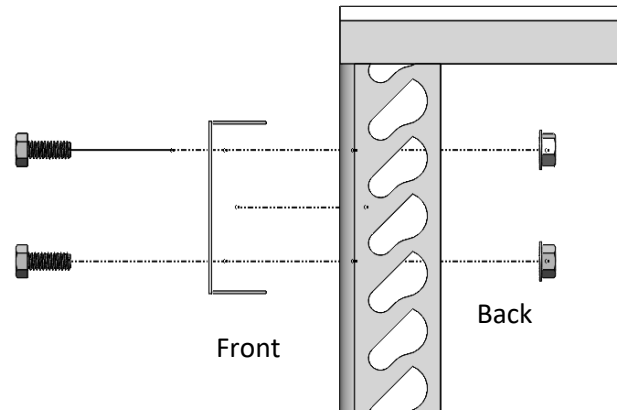

Sway Brace in the bottom will be attached using the 2 top holes

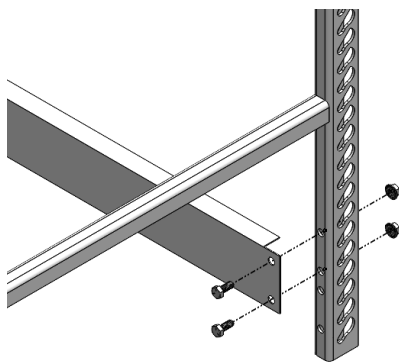

Detail B

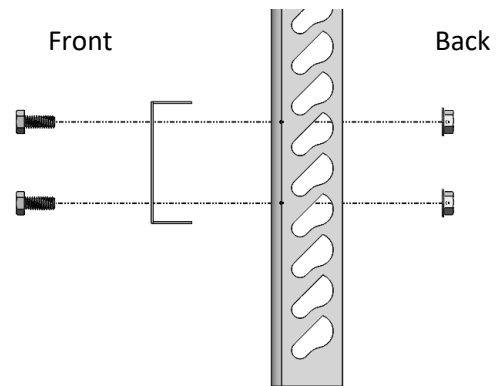

Door frames are done in 2, 3, 4 & 5 door sections, 5 is the maximum number of doors per section. Shelving frames must follow the door frames. The division between door frames will be seen by looking for a T-bar from the customer side of the doors, or by looking for where you see two lights on the merchandise side of the doors.

Front View

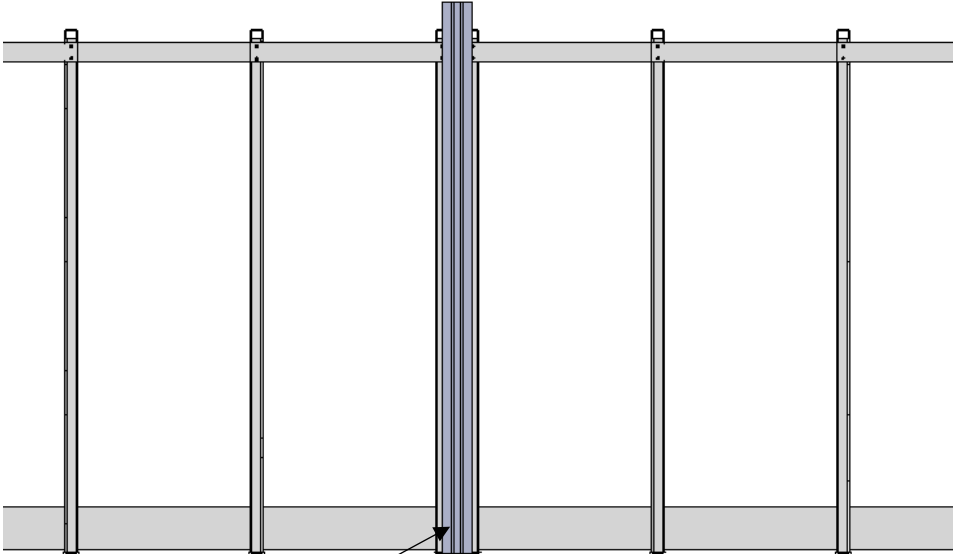

Door Break (T-bar)

Top View

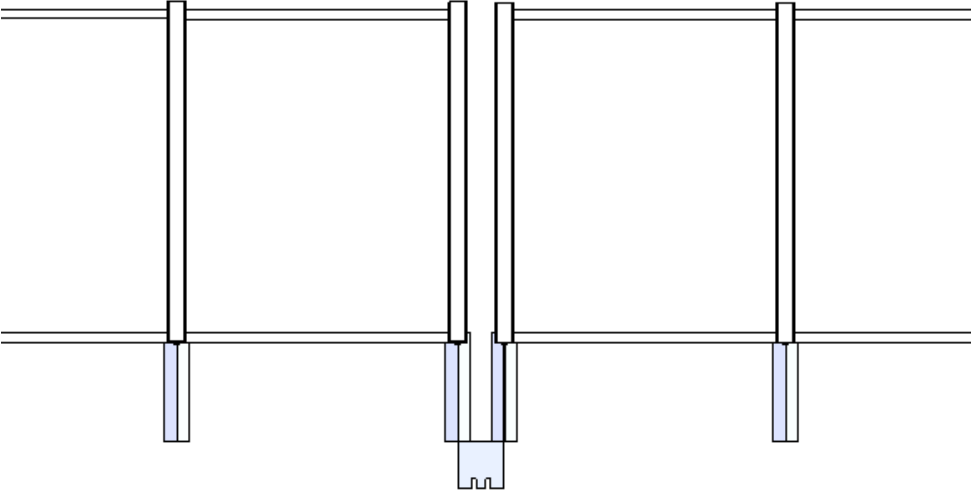

Door Break (T-bar)

**Step 2:** Use spacers to set the clearance from the Frame to the door.

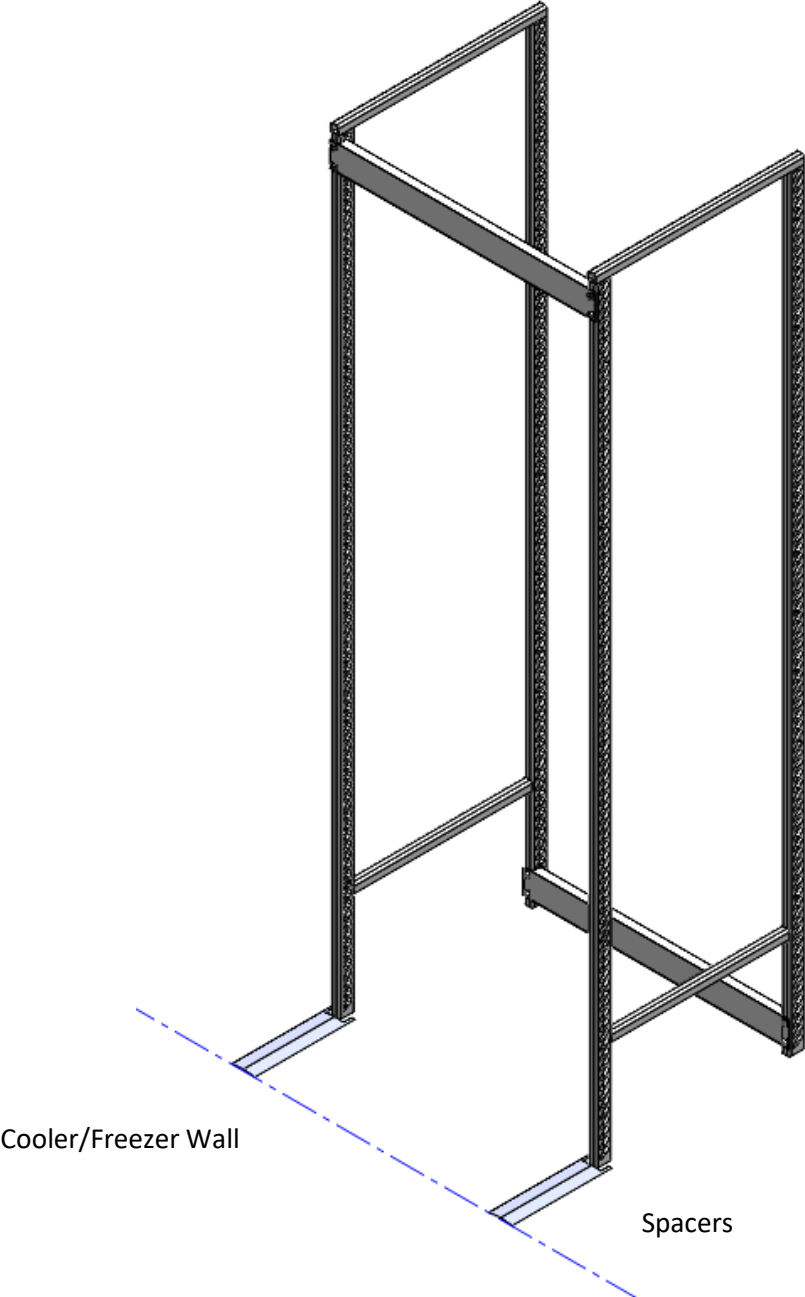



**Step 3:** Set Shelf clamps on the Upright frame to attach the Shelves.

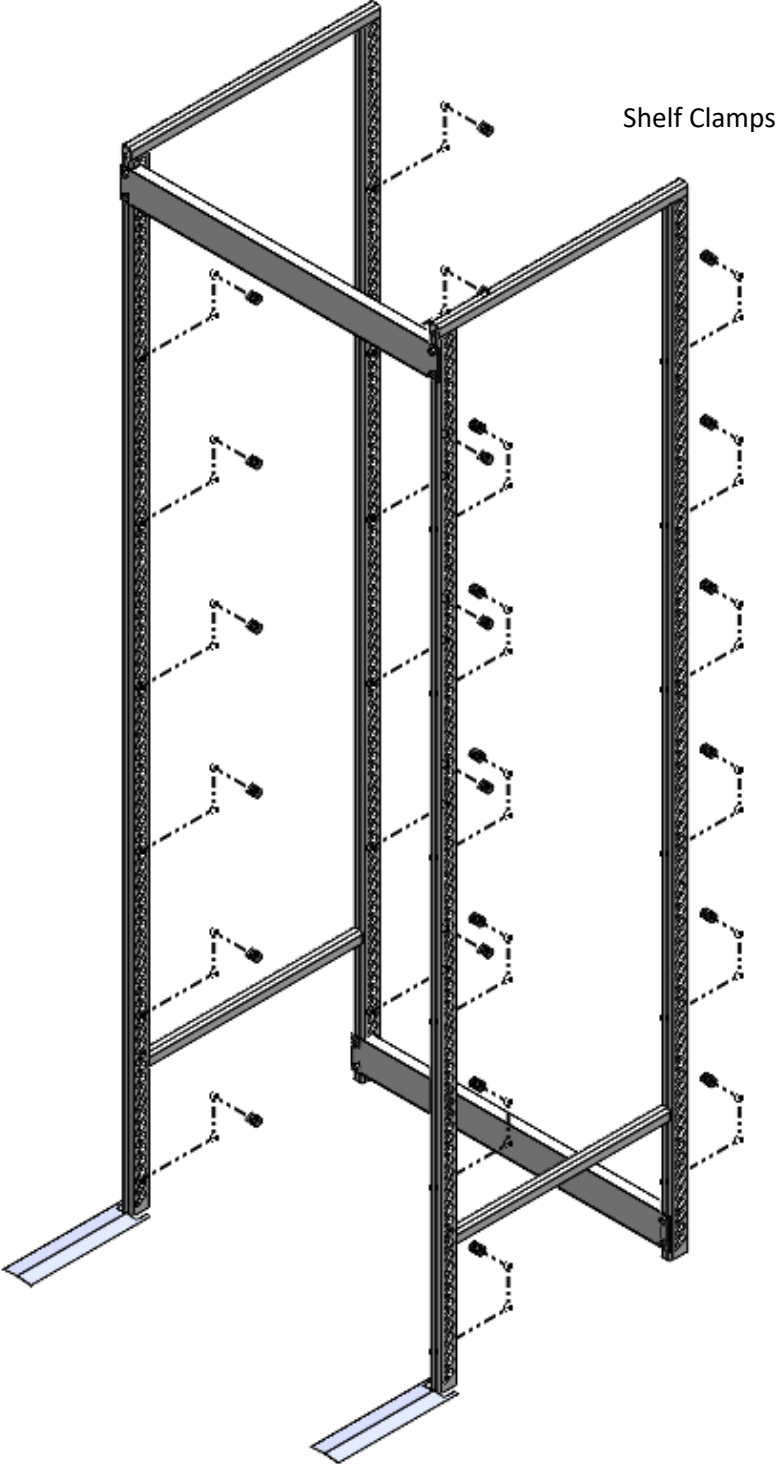

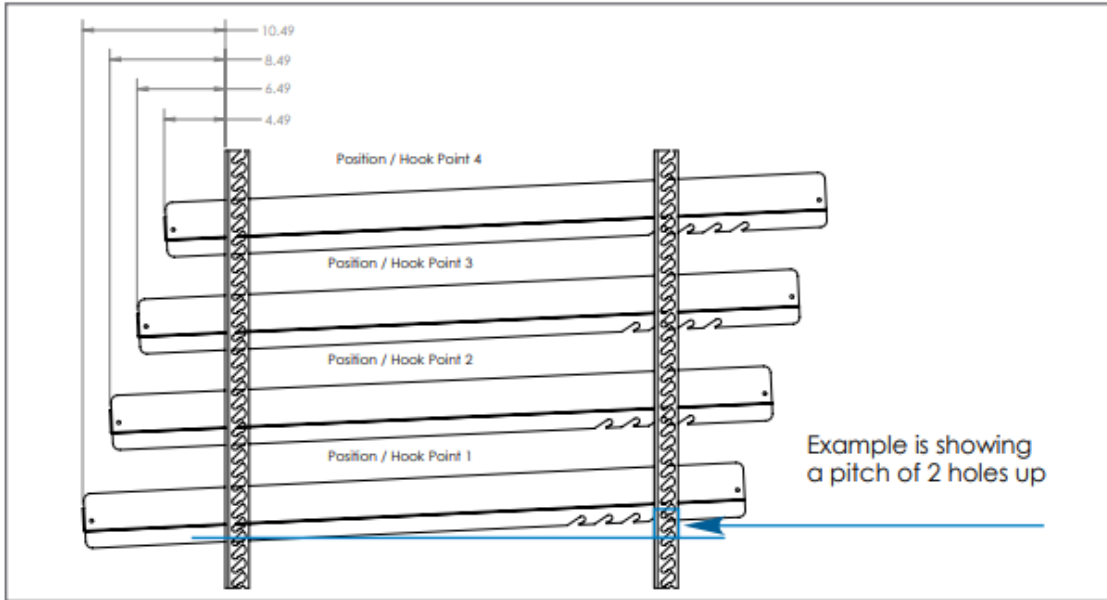

## 27" Shelf Depth

Product	Number of keyholes notches up
Plastic beverage	3
Carton beer	4
Cardboard water	4
Liquid dairy	3
Liquid dairy	4
Glass packaged	2

**Step 4:** Install top and bottom shelves **ONLY**. Use level to make sure rack is plumb.

Shelves

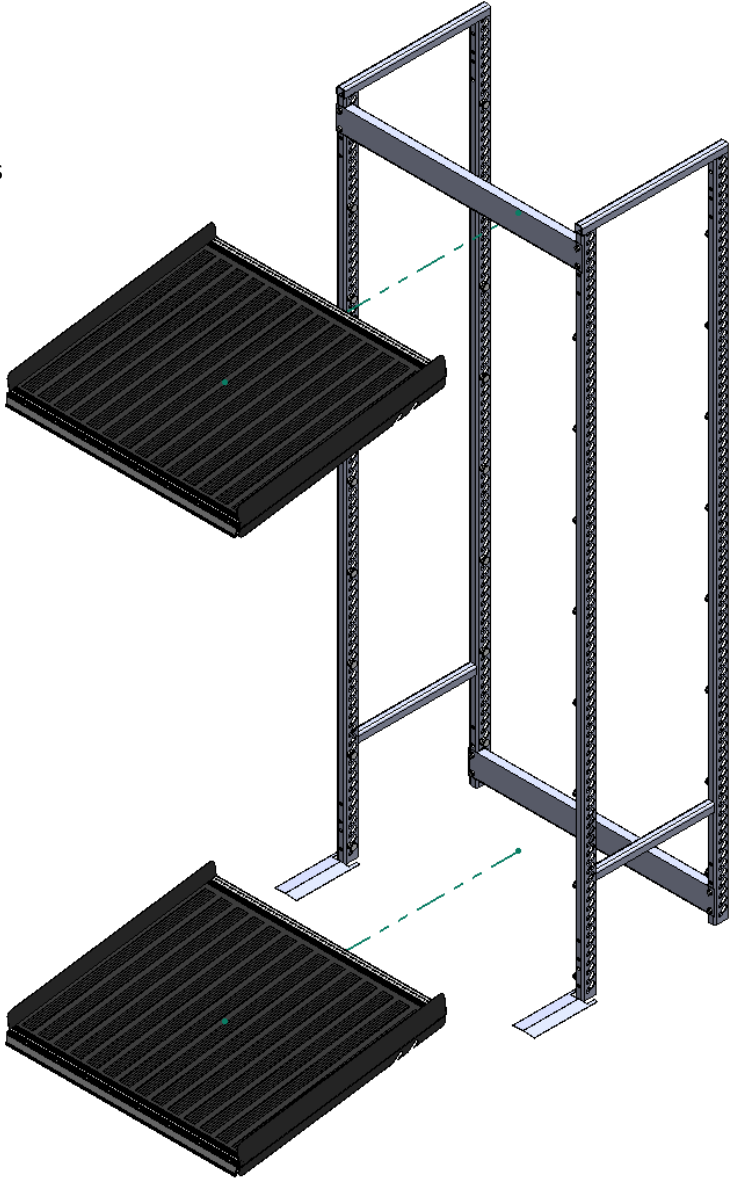

Front

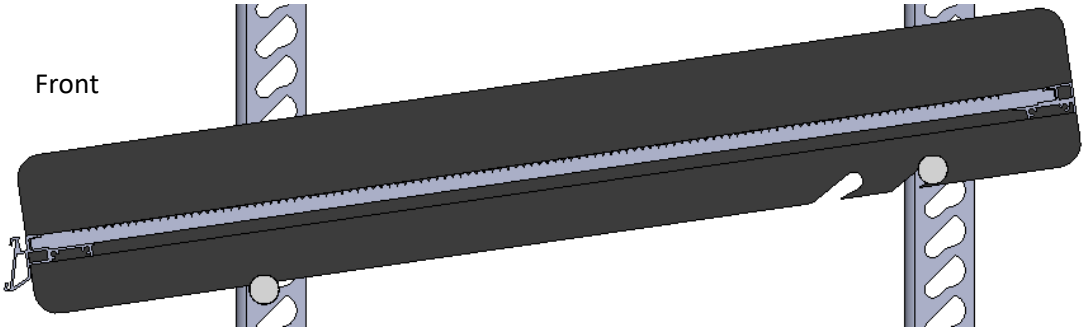

Back

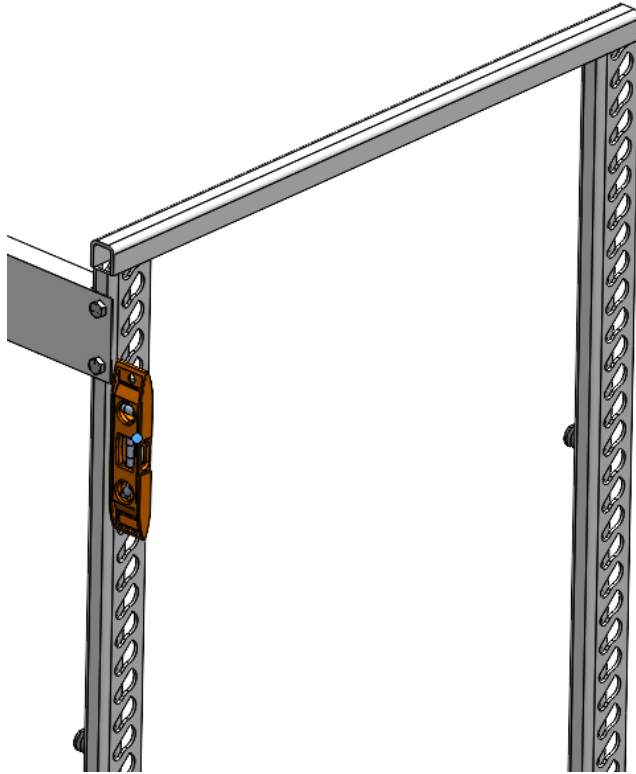

Step 5: **Tighten** all the bolts and nuts using the wrenches.

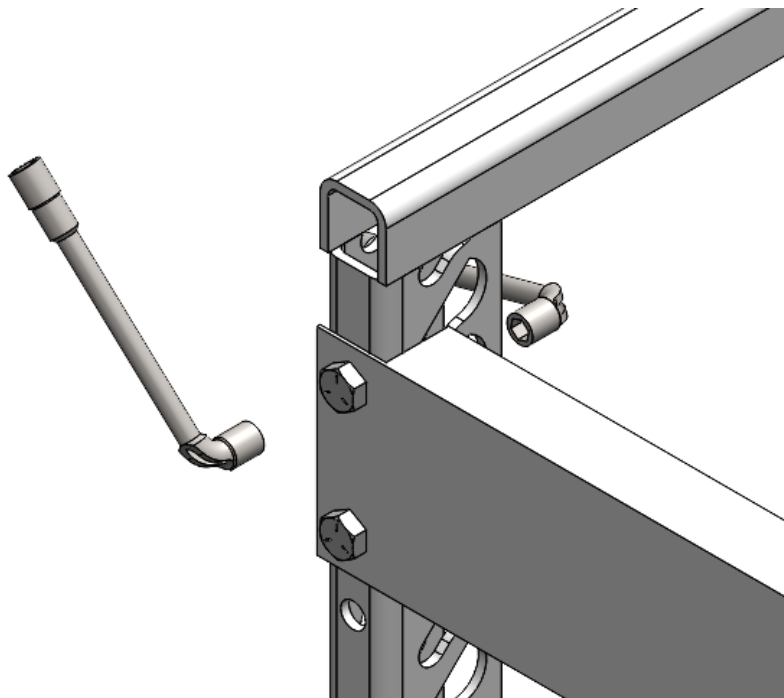

**Step 6:** Install remaining Shelves.

Shelves

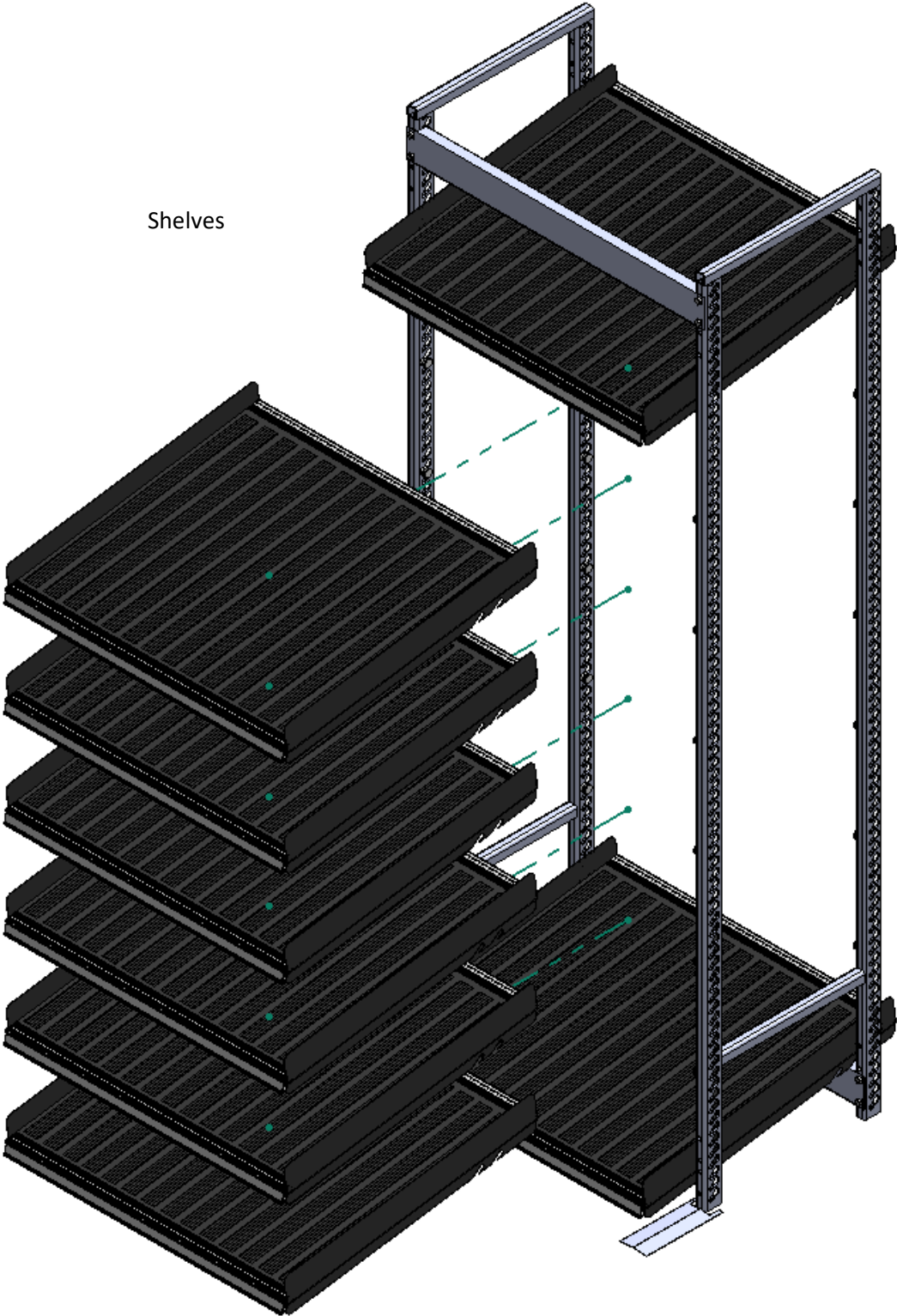

**Step 7:** Install Lane dividers as needed based upon product displayed.

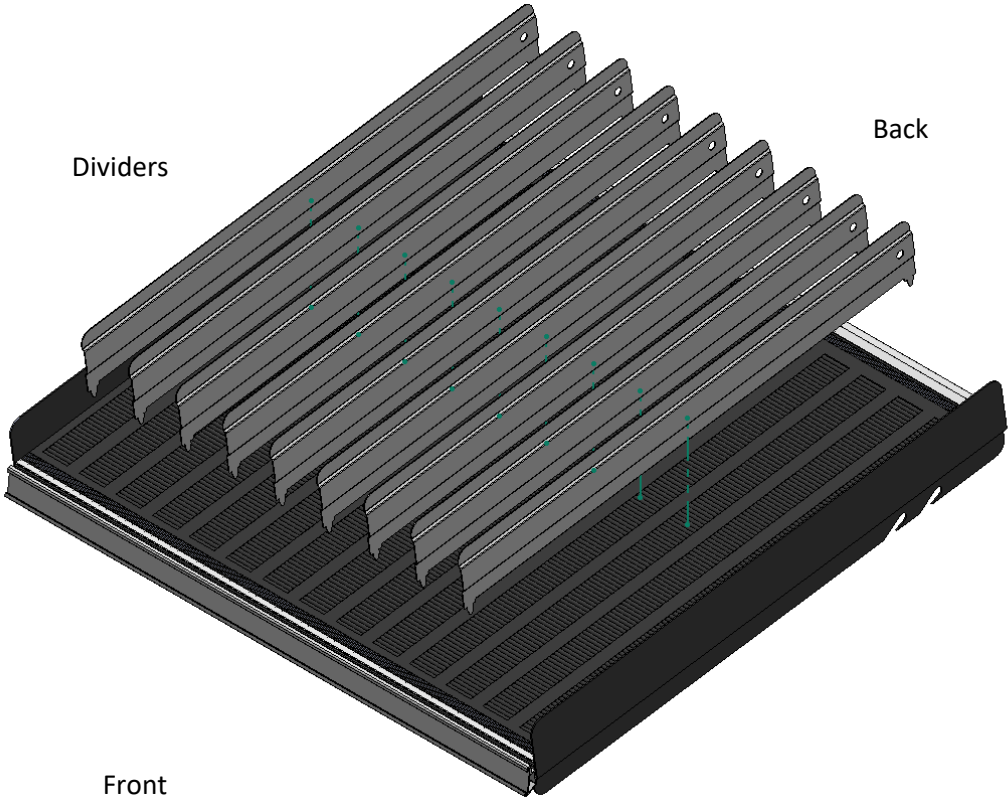

Dividers to be secure in the slots, round side must be up and all indents must go the same way in each shelf

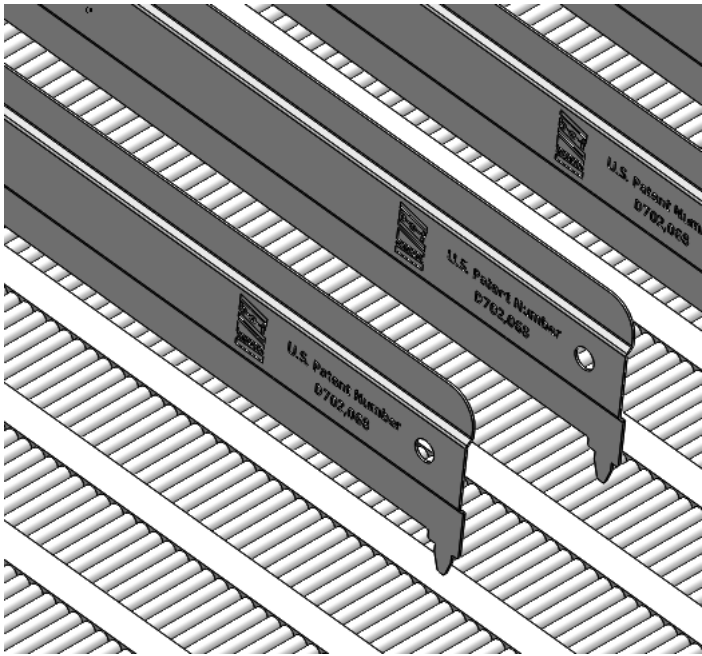

Laying two products down in each lane is a helpful way to set lane dividers.

**Step 8:** Install Plexiglass front product stop into the Front Price Tag Moldings by sliding it on the side.

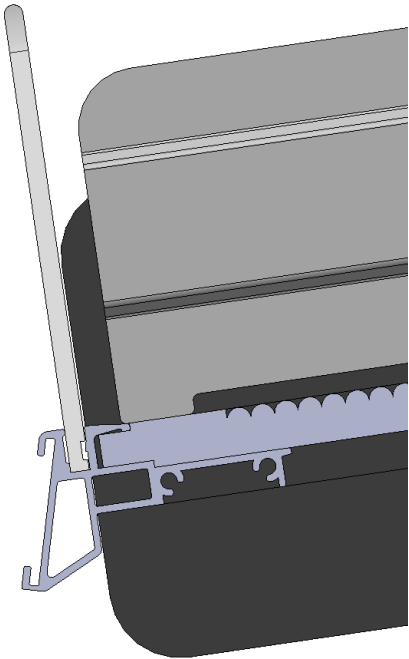
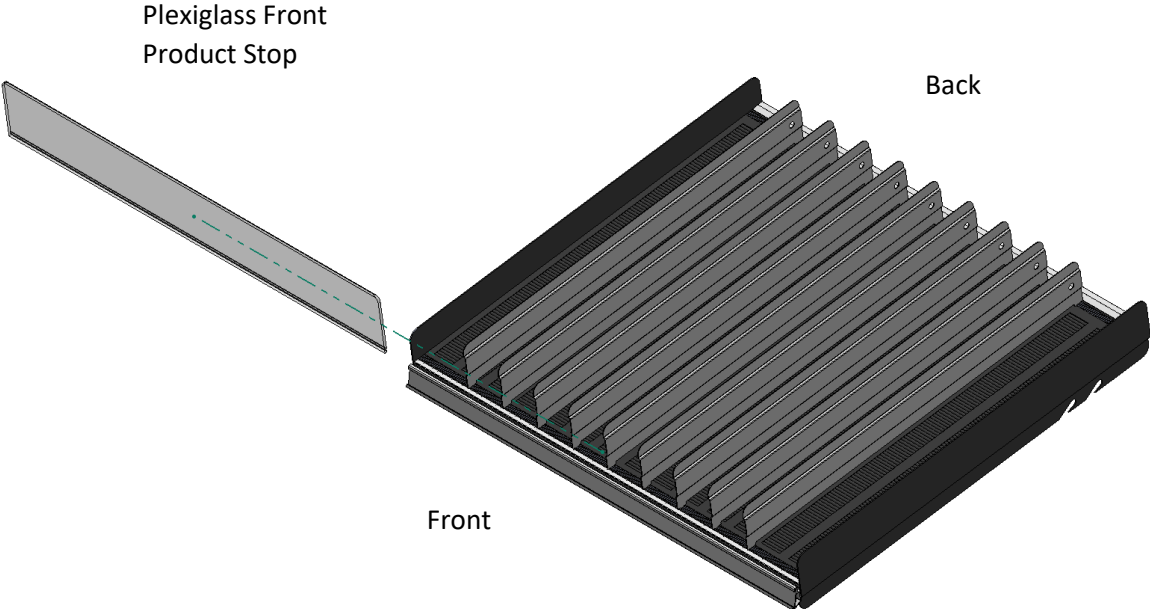



**Completed Assembly:**

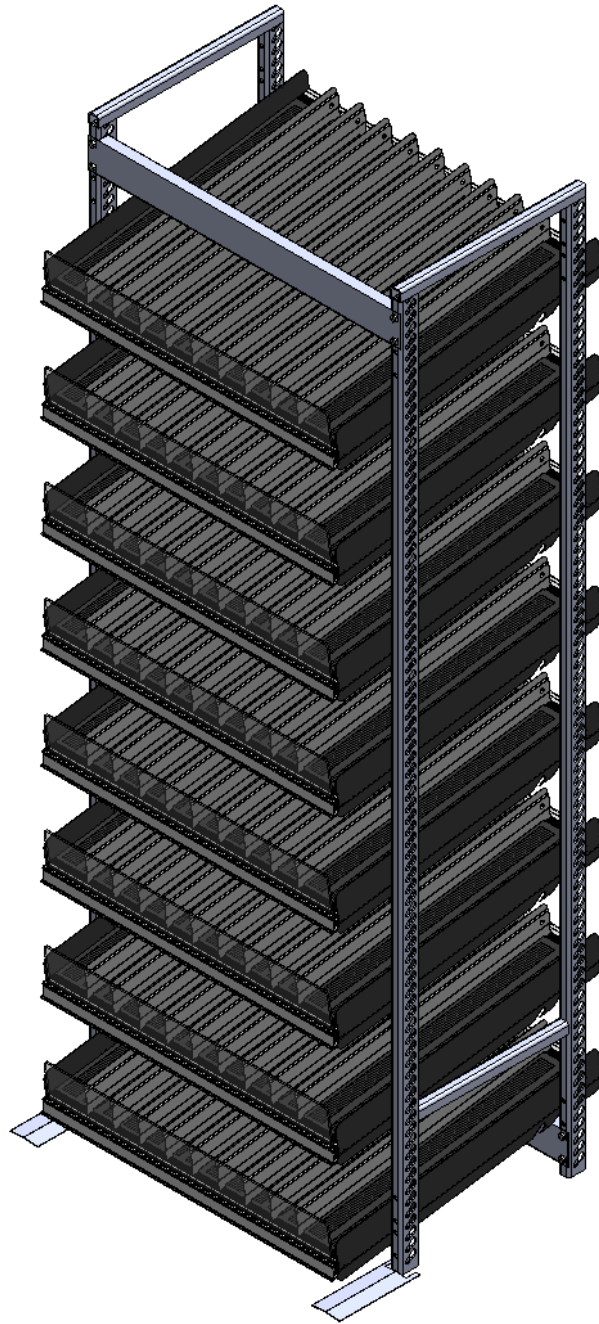

**Questions?**

**Call Customer Service...800-323-2517**